

## DryLock® 2 Assembly for A9 Pumps Version 2.2

### \*\*DryLock® II Product Update\*\*

The latest update builds upon the reliable features and benefits of the base DryLock® 2 system in use since 2011 but now with reduced parts. We have designed a new unitized rotary seal sleeve (5H) that replaces four prior components: rotary seal ring (5N), seal sleeve (5G), locknut (5M), and rotary seal o-ring (5P). The new unitized rotary seal sleeve reduces cost, complexity and assembly time over the previous iteration and is fully interchangeable with all versions of the DryLock® 2 Static Seal.

### 4 Piece Rotary Seal Sleeve (Version 2.1)

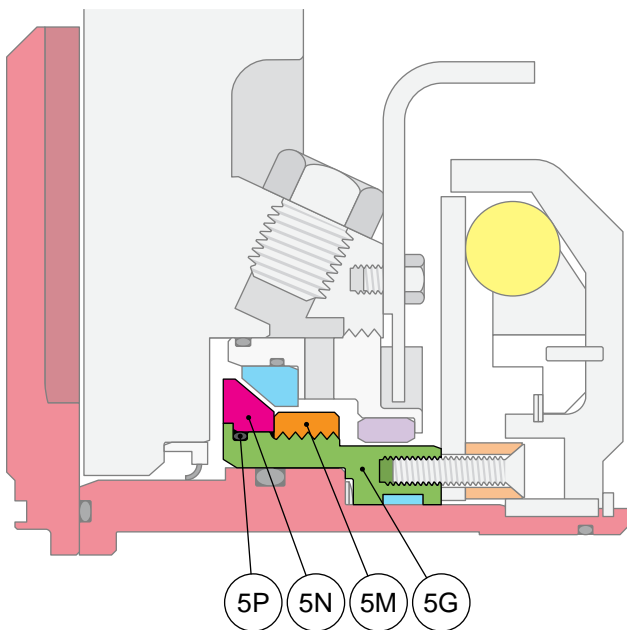

### 1 Piece Rotary Seal Sleeve (Version 2.2)

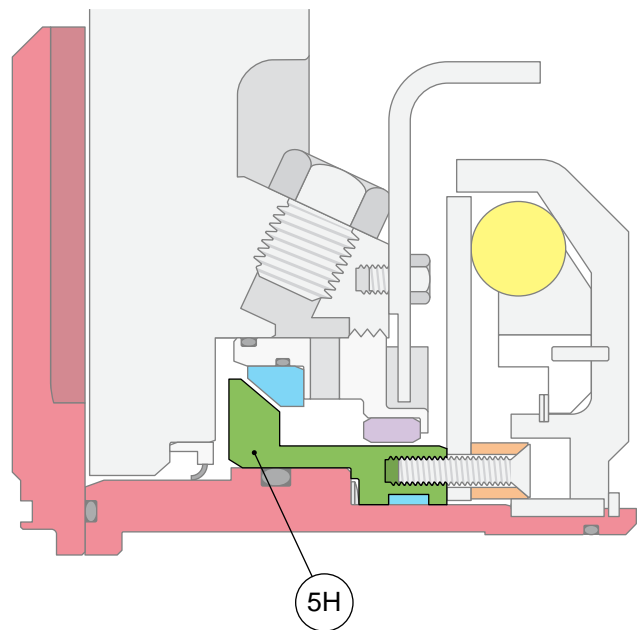

## Setting the Seal Clearance

**Seal clearance MUST be set after the assembly has been installed in the pump**

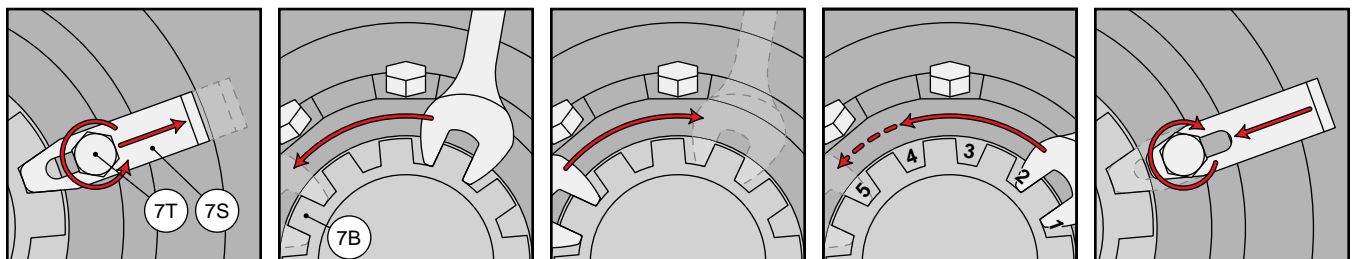

Loosen  
posi-lock bolt (7T)  
Disengage  
posi-lock pin (7S)

Loosen seal cartridge (7B)  
minimum 1 visible thread

**\*Set impeller clearance\***  
Tighten seal cartridge (7B)  
until it bottoms out

Loosen seal cartridge (7B)  
to set seal clearance  
4 full tabs (frames 1-2)  
5 full tabs (frames 3-5)

Reengage  
posi-lock pin (7S)  
Tighten  
posi-lock bolt (7T)

**Refer to the A9 operating manual for complete instructions**

